

*It is proposed by the River Heights City Planning Commission that the current fence regulations be combined into their own section. Underlined portions are to be considered for inclusion.*

**10-12-4: FENCE REGULATIONS**

- A. Fences and Walls Maximum Height (from sidewalk or road grade)
  1. Front Yard: 4 feet
  2. Side Yard, Interior Lot: 6 feet
  3. Side Yard on a Street (except corner lot): 4 feet or, 6 feet 90% transparent
  4. Side Yard on a Street (corner lot): 4 feet or, 6 feet 90% transparent (See 10-23-5)
  5. Rear Yard: 6 feet
  6. Rear Yard on a street (except corner lot): 4 feet or 6 feet 90% transparent
  7. Rear Yard on a Street (corner lot): 4 feet or, 6 feet 90% transparent
- B. No Permit Required: The City does not issue permits for fences, HOWEVER, fences built outside city code regulations will be brought into compliance at the owners' expense.
- C. Replacement of a Fence: When replacing an existing fence, the new fence must be brought into compliance with the current city code.
- D. No Chain Link: Chain link is not allowed in the front yard, side yards on a street, and rear yards on a street.

Corner Lots: When the rear yard of a corner lot is adjacent to the front yard of a neighboring lot, a 6 foot (6') fence is allowed in the part of the corner lot's rear and side yard that is adjacent to the neighboring lot's front-yard setback area (4 feet or, 6 feet transparent is required within setback). All fences on corner lots shall comply with 10-13-15: Clear View of Intersecting Streets shown in the following figure.

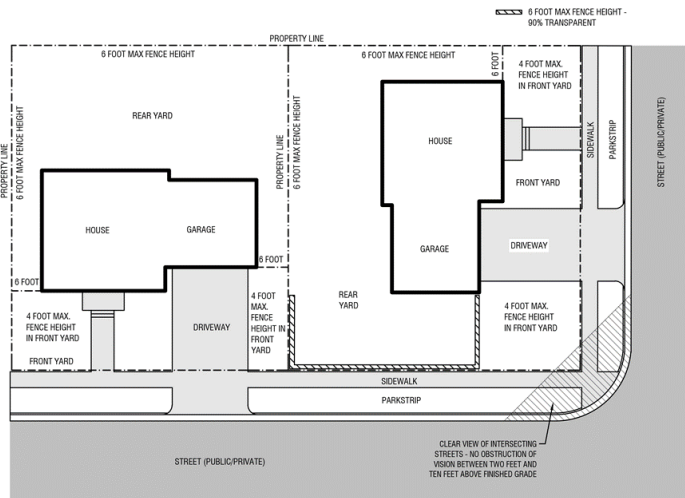

**10-3-4:B** Requirements; Zoning Clearance Permit: . . . required for the following:

- 2. — Fences in the required setbacks;

**10-12-2:A** Remove “Fences and Walls” section of Table 2, including note 3 and figure 10-12-2.